



Thank you for choosing to cruise with Captain Cook Cruises.

Your e-ticket is issued subject to the terms and conditions of the Passenger Cruise Contract.

For your convenience we have included:-

- A-Z helpful information
- Cruise summary
- Sample cruise itinerary
- Sample map
- Deck plan
- Passenger Cruise contract

Check in

Check in locations and times vary depending on your cruise:-

Yasawa Island Cruises (3, 4 & 7-Night Cruises) & Northern Fiji Discovery Cruises

- Cruises depart Port Denarau Marina, Nadi – Luggage Check in is available from 9am – 12 noon. Port Denarau Marina has a wide range of retail outlets, bars and restaurants.

Getting to your cruise

- All passengers are required to make their own way to Port Denarau Marina. On arrival in Fiji please visit or telephone one of our Fiji Offices to reconfirm your booking. Our Nadi Airport Office is centrally located at the Arrivals Concourse and can assist with visitor information.

Fiji Offices

- Port Denarau Marina - Cruise Counter: Daily 8am–9pm – Reservations Ph 675 0504
- Port Denarau Marina – Central Reservations & Administration Office: Daily 8am-5pm – Res Ph 670 1823

Taxis

Taxis are readily available from Nadi Airport and most Nadi/Denarau hotels.

- Airport to Port Denarau Marina – taxi approx FJ\$35 / 30 minutes
- Nadi to Port Denarau Denarau Marina – taxi approx FJ\$25 / 10 minutes
- Port Denarau to Airport – taxi approx. FJ\$45

What you will need at Check-in

The following information is required at check-in

- Photo identification for each passenger (driver's license or passport)
- Your Captain Cook Cruises confirmation number (located on your e-ticket)
- Your credit card (as security against your onboard Cabin account)

You will then need to register by completing your Booking Form (if not already completed)

Captain Cook Cruises is a small ship cruise operator. **Once we leave the wharf the ship cannot obtain additional supplies or medicines. Special requests or dietary requirements must be advised to your booking agent as early as possible. Upon boarding please consult with your Hospitality Manager. Please also ensure you bring any prescription medication you may need.**



MV REEF ENDEAVOUR – FIJI ISLANDS A TO Z HELPFUL INFORMATION

The following information is a guide only and is subject to change. Kindly note that it is your responsibility to ensure you have all the correct documents including visa, health and passport requirements. Please check with your local authorities before you depart. For information & details of passenger responsibilities please refer to the passenger cruise contract.

ACCOMMODATION (Reef Endeavour) - 64 suites, staterooms and cabins. Tabua Suites and B & C Ocean Staterooms have two windows per room and open onto the outside deck. Porthole Cabins open to an inside passageway and have port holes. Each room has a private bathroom ensuite, on/off air-conditioning, hair dryers, 240 volt power, international shaver point, soaps, shampoo and towels; serviced daily. Each Cabin & Stateroom is approximately 14sq metres and Suites are approximately 28sq metres.

AIR CONDITIONING - Each Cabin/Stateroom contains at least one air-conditioning vent. A simple on/off switch & temperature gauge is located under the main light switch. If you wish to leave your cabin door open, please switch off the air-conditioning. There is a fresh air vent located on the bottom of Stateroom & Tabua Suite doors which can be opened if you choose.

BAGGAGE - Baggage is limited to what you can stow in your cabins, so you would be advised not to over pack. There is a storage area under each bunk. All bags must be clearly labeled with your name and cabin number. Bags have to be handled by crew and we would appreciate a weight limit of 20kg

BARS – Normal closing time for bar services is 12 midnight. Our licensing laws do not permit alcohol to be brought onboard by passengers.

BIRTHDAYS & SPECIAL OCCASIONS - You may want to order a cake, champagne or make some other celebratory arrangement for that special occasion. Please give two weeks' notice before sailing.

BOARDING – The vessel departs from Port Denarau Marina unless otherwise stated. Please present your ticket, e-ticket or agency voucher with photo identification at the Captain Cook Cruises counter in the Port Terminal. The crew will load your baggage. Check-in is 9.00am - 12noon for a 1.00pm departure on Tuesday and a 12noon departure on Saturday.

BRIDGE – The Captain will schedule a time for a bridge tour when operationally possible. Please listen for announcements of the schedule or check with your Purser.

CASH FREE: - For your convenience we operate a cashless system. You may use your Cruise Account for onboard drinks and some optional shore excursions. Small denomination local currency is required for village markets, games and gratuities. Your Cruise Account must be settled at the Purser's office prior to disembarkation. Limited foreign currency, cash or credit card (American Express, Visa, MasterCard – small surcharge) will be accepted for payment of your account, however we advise personal cheques cannot be accepted.

CHILD MINDING – All children must be under the supervision of an adult at all times to the satisfaction of the ship's Master and must be able to swim unaided or be prepared to wear a flotation device on all tender transfers. Children 5-10 must be under the supervision of a responsible adult at all times. Group child minding is provided on board for children 5-9 years inclusive at the following times 9.00am-12noon, 2.00pm -5.00pm, 6.00pm-9.00pm. Infants under 5yrs are not accepted. Child rate applies to children 5 – 17 years sharing with adults.



COFFEE & TEA – 24hr Complimentary coffee & tea are available in the Yasawa Lounge and the Reef Room. Espresso Coffee is also available at the bar.

DAY TOURS - Captain Cook Cruises offers a complimentary choice of tours for 7-Night passengers these are also available to purchase for those disembarking who wish to utilise their time on a Tuesday or Saturday (whilst the ship is docked at Port Denarau Marina). Please enquire at the Purser's Bureau.

DIETARY NEEDS - Passengers requiring special meals should advise the Company in writing at least two weeks prior to sailing and discuss with the purser on boarding. Most special diets can be catered for but we do need to be able to prepare for you in some cases.

DINING – Dining is a vital ingredient in your Fijian cruise. Whether it is an alfresco luncheon, gourmet barbecue or table d'hote dinner, our food is prepared on board from fresh local and imported produce and our on-board entertainment adds a special flavour to the mix. Breakfast 7.30am – 9.00am. Lunch 12noon or 12.30pm. Dinner reservations from 7pm to 8pm or as otherwise advised. There is one sitting for meals. Table seating is assigned by the Hospitality Manager for most evening Dinners whilst Breakfast and Lunch are free seating. Please advise if you have any special requests.

DISSEMBARKATION – On the final day of your cruise, please leave your luggage outside your cabin prior to breakfast (it will be landed ashore by the ship's crew) and return your key to the Purser's Bureau. All cabin accounts must be settled at the Purser's Bureau between 7.00am and 8.00am. The Ship's crew will farewell you around the swimming pool at 8.45am before disembarkation at 9am. It is possible to disembark 7.30am-9am but please make prior arrangements.

DIVING – Reef Endeavour is Five Star PADI. Dive opportunities are at an additional cost for both certified and 'first time' divers. All certified divers must present an internationally recognized Open Water Dive Certificate to the on-board dive instructor to participate in certified dives. Introductory (or beginner) divers are not required to have a certification card however they will need to complete a medical and waiver form. To avoid disappointment, passengers with any health issues or taking any medication, should visit their doctor to obtain a fitness to dive certificate prior to embarkation (not available in Fiji). Divers should register your interest with Reservations when booking your cruise. Up to 4 dives on a 3 night, 6 dives on a 4 night and 10 dives on a 7 night cruise can be pre-booked. Additional dives may be available subject to conditions. Passengers participating in the Open Water Dive Course are able to complete their academic learning component prior to boarding at www.padi.com

DRESS CODE – During the day, sportswear and casual clothes are suggested. We kindly ask that you do not wear uncovered bathing suits or beach attire in public rooms and lounges, especially in the Dining Saloon. Footwear is requested in Lounges and is mandatory in the dining saloon due to Fiji Health regulations. During the evening smart casual wear is recommended – an open neck shirt and slacks for gentlemen and a dress, skirt and blouse or slacks for the ladies. The first night of each cruise is the Captain's Welcome Dinner which is an opportunity for you to dress up should you choose. Be sure to bring a sun visor or hat, sunglasses (Polaroid), insect repellent and good sun block on shore excursions. Sandals, low-heeled deck shoes and tennis shoes are most suitable on deck and for shore excursions. Hiking boots may be preferred on island hikes. Please be aware there are some wet landings and most beaches are not groomed so bring shoes that you can wear in the water. Fijians dress modestly and revealing clothing is not accepted in public places. Please cover your shoulders and knees (bula shirt & sulu are ideal) and remove headwear and sunglasses when visiting villages.

DRINKING WATER – The water from your cabin tap is suitable for drinking. There is also filtered water at the Coffee station in the lounge. The ship also supplies drinking water for passengers when visiting islands.



DUTY FREE - There are no duty free facilities onboard. Duty free Alcohol may be left with the office for safe keeping and may not be brought aboard due to Fiji licensing laws.

DVDs – There are selection of DVDs available to view in the Reef Room at the Purser's Bureau

ELECTRICS - The ships electricity is AC 240 volts 50 cycles (standard electrical power used in Australia) and there is an international shaver point in the bathroom.

ENGINE ROOM TOURS - We regret due to insurance constraints, we are unable to conduct engine room tours.

EXCURSIONS - During the cruise a number of shore excursions are available (charges may apply). You may be requested to book your preferred times for shore excursions. As a courtesy to your fellow passengers, please be prompt to your marshalling station on the Pool Deck (details will be provided in your daily onboard itinerary) with any items you may need including sunglasses, sunscreen, insect repellent, hat, bathers, towel and reef shoes (for wet landings) or hiking shoes for mountain hikes. Remember to cover your shoulders and knees and remove hats and sunglasses when visiting villages.

FACILITIES - Swimming pool, spa, sun deck; glass bottomed-boat, snorkeling and dive vessels; pool side bar, cocktail bar with baby grand, lounge, single-sitting dining saloon and briefing/conference room; gift shop, chart house, library and DVDs; self-service guest laundry and 24 hour coffee and tea facilities.

FOOTWEAR – We recommend footwear you can wear in the water as some beaches are not groomed and it can be a wet landing at low tide. We also offer mountain hikes so hiking boots are an advantage.

GAMES – Games and puzzles are available in the Reef Room/Library. Please feel free to make use of the games but please return them to the shelf

GIFT SHOP - Adjacent to the Purser's Bureau, the Gift Shop is open between 8.00am and 12 noon and 2.00pm and 6.00pm each day and stocks a range of souvenirs, a small amount of toiletries, clothing, film, stamps, confectionary and bottle water. All purchases will be charged to your Cabin Accounts

GYMNASIUM – Reef Endeavour has a mini Gym for your convenience. For safety reasons, children under the age of 16 years are not permitted to use the equipment unless accompanied by an adult.

KAYAK – there are kayaks & SUPs that travel with the ship and are available for use at most stops. There are also some optional guided kayak tours on some itineraries.

LAUNDRY – The passenger laundry contains a washing machine, tumble dryer, ironing board, iron and washing tub. There is a small nominal fee for this self-service facility. Tokens & washing powder available from the purser's bureau. For line drying clothes on the Reef Endeavour, both the Stateroom and Tabua Suite have a line outside of the room. Please bring your own pegs to ensure clothes are secure. Captain Cook Cruises will take no responsibility for any loss of items.

LIBRARY / REEF ROOM - The reef room has a selection of books, games, TV, DVD library and 24 tea and coffee facilities. Kindly return or swap the books with one you have brought so that others can enjoy them.

MAIL – Mail deposited in our post box at the Purser's Bureau will be cleared at the completion of each cruise. Stamps are available from the Purser's Bureau.

Tunsa P/L TA Captain Cook Cruises Fiji ABN 63 001 364 487

PO Box 349 Milsons Point NSW 1565 **Call** 1300 TOFIJI (1300 863454)

International +61 2 9126 8160 fiji@captaincookcruisesfiji.com or +679 6701 823

Captain Cook Cruises Management Ltd Captain Cook Cruises Building, Port Denarau, (PO Box 23) Nadi Town, Fiji.

www.captaincookcruisesfiji.com



MEDICAL- The ship's crew does not include a doctor, however the Ship's Officers are trained in First Aid and the crew includes a nursing sister on most departures for the administration of emergency medication. There is no pharmacy onboard. Please ensure you bring adequate prescription medicines you may require.

MEDICAL - FITNESS TO TRAVEL - The passenger warrants that they are physically fit and capable of undertaking the cruise. A certificate of fitness of travel by your doctor is required for passengers over 75 years of age and/or passengers with limited mobility. For full details please refer to the Passenger Cruise Contract.

MONEY EXCHANGE – Limited currency exchange facilities for most major currencies are available onboard. Please ask at the Purser's Desk. We recommend you bring Fiji dollars for island purchases.

NAVIGATOR – Each day an Officer will inform you of points of interest, the ship's current position and other nautical and relevant information. Charts showing the cruise itinerary can be found in the Lobby at the Purser's Bureau. Charts are also available for purchase and your course may be plotted.

ONBOARD CHARGES – From time to time onboard charges may apply. Onboard charges are not included in your cruise fare and are payable at the conclusion of your cruise. All amounts are charged to your onboard cabin account, payable at the end of your cruise by credit card or cash. Please note rates are subject to change.

PASSENGER CRUISE CONTRACT - Tickets are issued subject to the terms and conditions of the Passengers Cruise Contract.

PHONES – Whilst at sea you may pass urgent messages by marine satellite phone at an additional cost. Mobile phone coverage is limited to most anchorages as is wifi. Local sim cards are available for purchase at Denarau and Nadi Airport. Some of our longer itineraries have less coverage. Urgent messages from shore to ship are relayed by marine radio phone via our Nadi office ph. +679-670 1823 or email nadi@captaincookcruisesfiji.com

PURSER'S BUREAU – The Bureau is open from 8.00am to 12 noon and 2.00pm to 6.00pm. If you have any questions please stop by the Bureau.

SPA – Senikai Spa is located in Cabin 116 on A Deck and offer a range of spa treatments, beauty therapy, massage, wedding hair and makeup and hair braiding at additional cost.

SCHOOL DONATIONS – During your cruise you may visit one of the local schools. Children from many villages throughout the islands attend these schools. You are welcome to make a donation to the school or you may wish to bring pre-loved children's' books or stationary (exercise books, pencils etc.) which is in limited supply. Confectionary is not recommended.

SMOKING POLICY – All areas of the ship are designated **non-smoking** except the aft of B deck. This includes all public rooms, lobbies, dive tenders and especially cabins & Staterooms. Smoking is permitted on the aft end of B Deck from the top of the stairs to the stern rail. Please do not throw lighted cigarette ends, cigars or matches over the ship's side as these may be drawn into the ship's side opening and cause a fire. Please use trays provided. As a courtesy to your fellow passengers, please refrain from smoking pipes and cigars. Cigarettes aren't sold onboard.



Captain Cook Cruises™

FIJI'S CRUISE LINE

SNORKELLING – Snorkelling is available to all with a minimum level of fitness. Please disclose any medical conditions that may affect your ability to snorkel to the dive instructor aboard. Fins, masks and snorkels will be issued for each cruise. Please return them to the Dive Master before disembarkation. Unreturned equipment will be charged to your Cabin account at F\$100.

TIPPING - Tipping is always a personal matter and depends on whether you have enjoyed the service you receive.

TOWELS – Towels for use ashore are available from the Purser's Bureau. We kindly ask you to keep the same beach towel for the duration of the day to conserve water use. New towels will be issued each morning.

TURNDOWN - Each evening while you are dining, a stewardess will be conducting evening bed turndown and leaving a copy of the following day's itinerary.

VALUABLES – Safety deposit facilities are available through the Purser's Bureau. Captain Cook Cruises accepts no liability.

WIFI – Wifi is available on Reef Endeavour and located in the Tabua Suites and the Yasawa Lounge. It is intermittent as it is accessed via the mobile phone network in Fiji. Our longer remote north itineraries can have less coverage. You can also purchase a data sim at Nadi Airport in the arrivals hall for your tablet or smart phone.

WEATHER - A warm tropical climate, generally cooler in the evening and dryer from April - October. Temperature ranges from 20-28 degrees Celsius. Western side predominantly dry 24-32 degrees

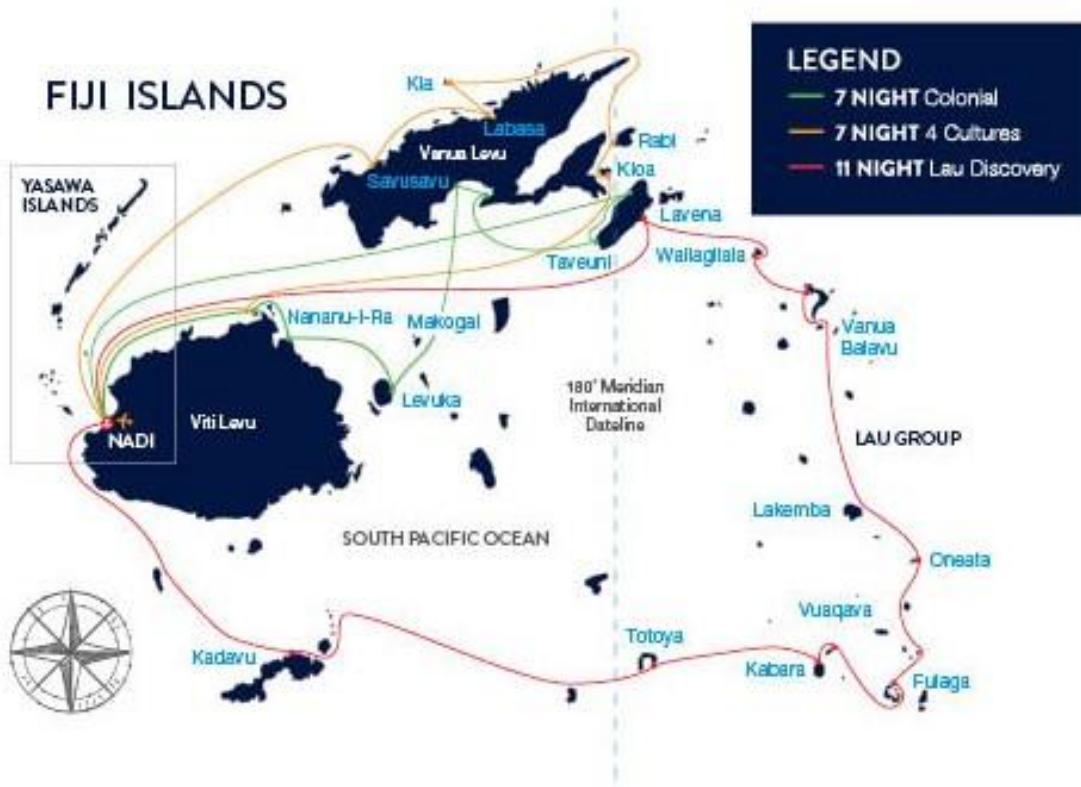

Reef Endeavour Ship Layout

Accommodation: MV Reef Endeavour has 63 recently refurbished Tabua Suites, Staterooms and Cabins.

Every cabin type features a private bathroom ensuite, on/off air-conditioning, hair dryer, 240 volt power, international shaver point, Pure Fiji soaps, shampoo & towels serviced daily. Each cabin is approximately 14sqm. Tabua Suites are approximately 28sqm. Staterooms and Suites open onto the outside deck and have two windows.

Tabua Suites (4) feature a bedroom (twin/double) with ensuite bathroom, plus a separate day room with, chair, settee, desk, TV & DVD player, refrigerator, tea & coffee facilities and second bathroom.

Connecting Family Staterooms (6) located on A & C decks (twin/double)

"B" Ocean Stateroom (33) located on A and B deck

"C" Ocean Staterooms (16) located on C deck

"D" Porthole Cabins (10) open onto an inside passageway (twin/double/bunk triple/bunk quad).

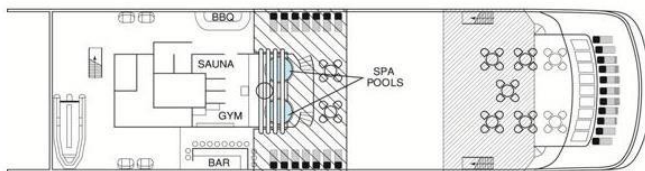

Sun deck

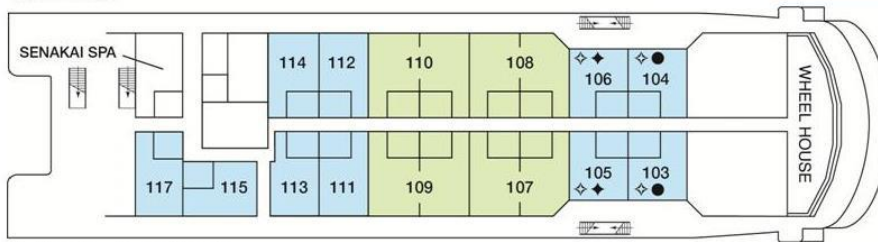

A Deck—Top Deck

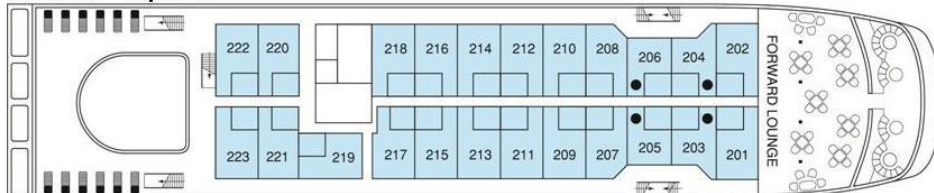

B Deck



C Deck

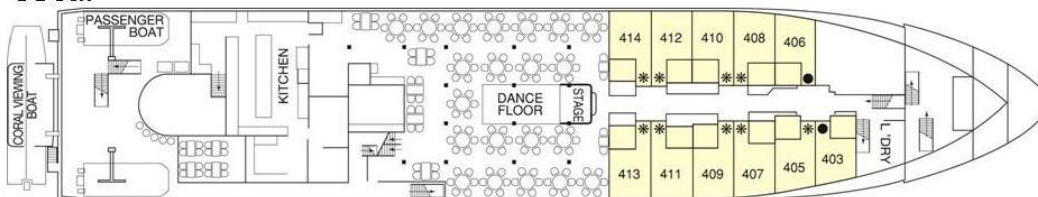

D Deck

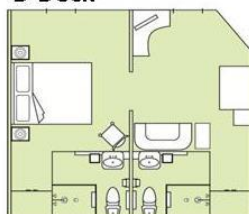

TABUA SUITE

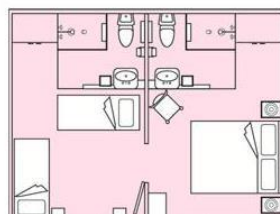

FAMILY OCEAN STATEROOM
A & C DECK



C OCEAN
STATEROOM



B OCEAN
STATEROOM



PORTHOLE
CABIN

LEGEND

All rooms have twin beds convertible to double bed unless indicated as follows:

- Double bed
- ◆ Twin beds
- ◇ Connecting Family Staterooms
- * Family Cabins – twin single beds plus two upper Pullman berths